

# BRCF 022

## Hydraulic Single-Acting Balanced Rotary Actuator 90° (Quarterturn) Fail-safe

B1

### Valve Adaption:

Adjustment screw, torque: max. 13 Nm – 110 lbf·in  
Fastening nut, torque: 35 Nm – 300 lbf·in

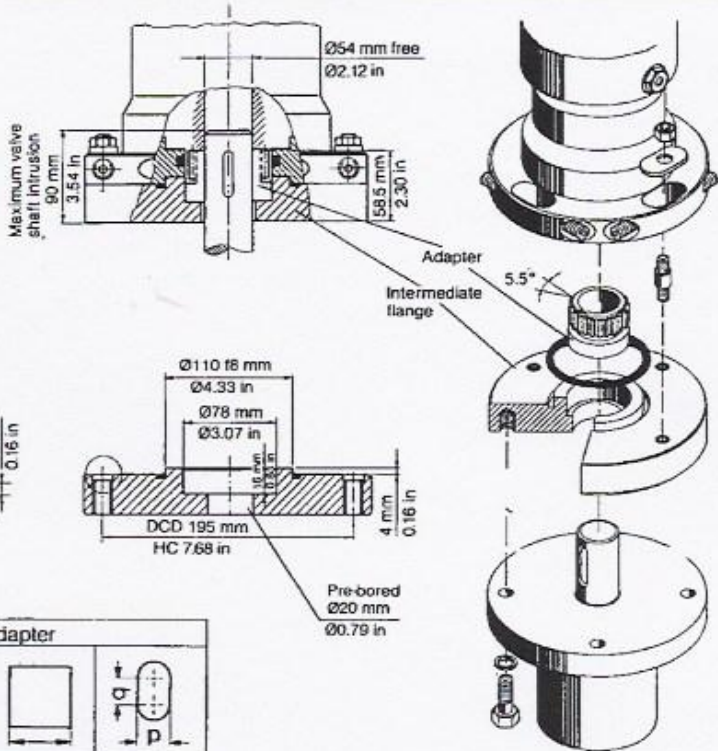
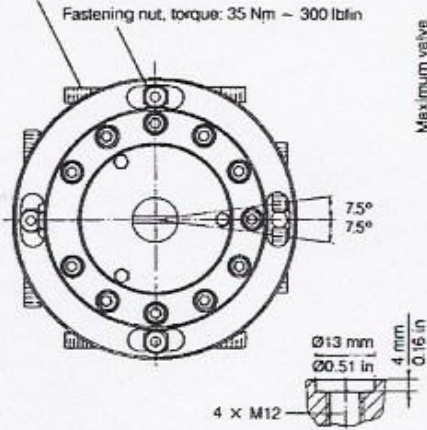

Limits for the Machining of the Adapter

Max. shape of valve spindle					
mm	42	42	42	35	p+q: 50
in	1.65	1.65	1.65	1.38	1.97

### Performance:

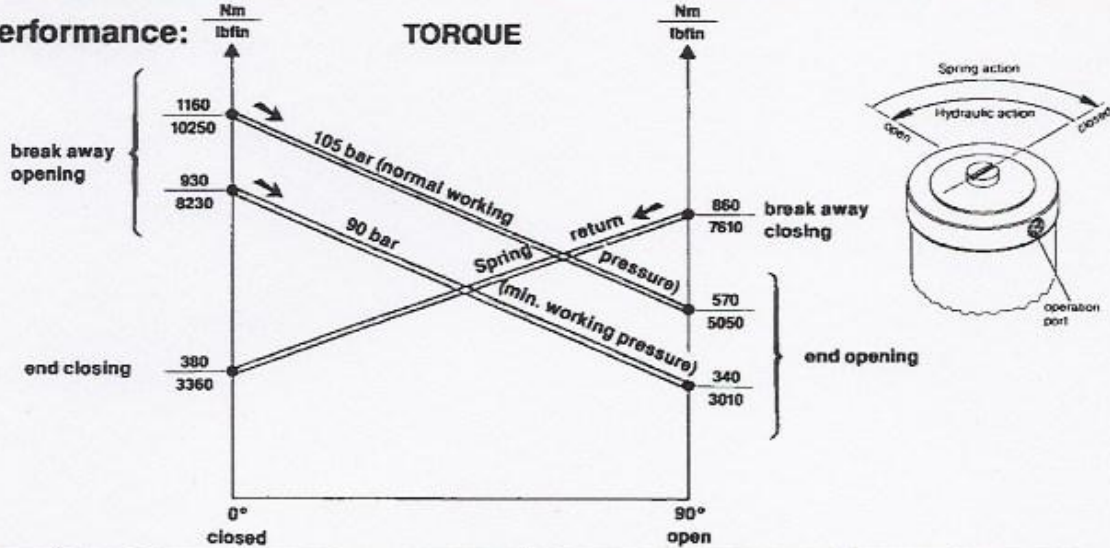

PARTS, SPARE PARTS, & MATERIAL LIST		COMPONENT TYPE & VERSION	
DANFOSS SYSTEM HYDRAULIK A/B		BRCF 022 - B1	
PSM NO. 160N4010		SHEET: OF: 2	
Notes: All items with stated ID nos. can be purchased as spare parts. When ordering spare parts - state ID no.			
DRAWINGS REFERRED TO:			
DRAWING NO.	REF.	DESCRIPTION	ISSUE
160N9203	a	Assembly Drawing	X
	b		
	c		
	d		
		900605 SV	

ITEM NO.	REF.	DESCRIPTION	CTM NO.	CTM P.M.O.
01	a	Housing	1 GGG 40	A10
02	a	160N4315 Top cover	1 GGG 40	A10
03	a	160N4320 Piston	1 GGG 40	A10
04	a	Splined member	1 GGG 40	A10
05	a	034D2601 Output shaft	1 SKP 280	B58
06	a	034C2612 Bottom member	1 GGG 40	A10
07	a	034E2621 Clutch member	1 GGG 40	A10
08	a	160N4310 Indicator shaft	1 S-1802	F10
09	a	034E2641 Disc	1 9SMnPB28	B50
10	a	051E6521 Top cover	1 MS 58	L05
11				
12	a	023-6771 Breather valve	1 MS 58	L05
13	a	O-ring 104,14x5,33	1 Buta	PD
14	a	X-ring 75,57x5,33	1 Buta	PD
15	a	X-ring 17,75x2,62	1 Buta	PD
16	a	X-ring 17,75x2,62	1 Buta	PD
17	a	O-ring 119,50x3,0	1 Buta	NBR
18	a	O-ring 114,50x3,0	1 Buta	NBR
19	a	Gasket	1 Chloropr.	
20	a	X-ring 17,75x2,62	1 Buta	PD
21	a	390-0015 Thrust bearing ø75	1 St-3	POL
22	a	390-0115 Thrust disc ø75	2 100Cr6	ROL
23	a	258-9141 Guide ring ø63/ø80x3,0	2 C75	Y03
24	a	231-1023 Disc spring 125/64x6,0 (5,70)	18 50CrV4	N15
25	a	250-0128 Screw M12x50 6K DIN 931	11 A4/80	8A4
26	a	251-3889 Screw M10x45	8 8.8	08.8
27	a	251-1054 Screw M5x12	DIN 912	7A2
28	a	251-7136 Pin screw M10x40	DIN 916	7A2

PARTS, SPARE PARTS, & MATERIAL LIST		COMPONENT TYPE & VERSION	
DANFOSS SYSTEM HYDRAULIK A/S		BRCF 022 - B1	
PSM NO. 160N4010		SHEET: OF: 2	
Notes: All items with stated ID nos. can be purchased as spare parts. When ordering spare parts - state ID no.			
DRAWINGS REFERRED TO:			
DRAWING NO.	REF.	DESCRIPTION	ISSUE
160N9203	a	Assembly Drawing	X
	b		
	c		
	d		
		900605 SV	

ITEM NO.	REF.	DESCRIPTION	CTM NO.	CTM P.M.O.
29	a	266-0007 Locking disc M10 DIN 6798	8 C15	
30	a	208-0053 Copper disc ø17/ø22x1,5	2 Copper	L02
31	a	Name plate	1 Stainless	F90
32	a	260-0412 Pin ø1,9x5	4 Stainless	8A4
33				
34				
35	a	Glydzing ø120/ø104,5x6,3	1 Turcite 46	PF1
36				
37				
38				
39				
200	a	230-0044 Adhesive open/shut sign plate	1 Stainless	5A2
300	a	Eye bolt M10 C15-DIN 580	2 Fzb	

160N4259 Seal set BRCF 022 - B1  
 Consisting of item 13-14-  
 15-16-17-18-19-20-35.

LUBRICATED WITH MOLYCOTE

TO RETAIN POS.23 USE ONLY MOLYCOTE

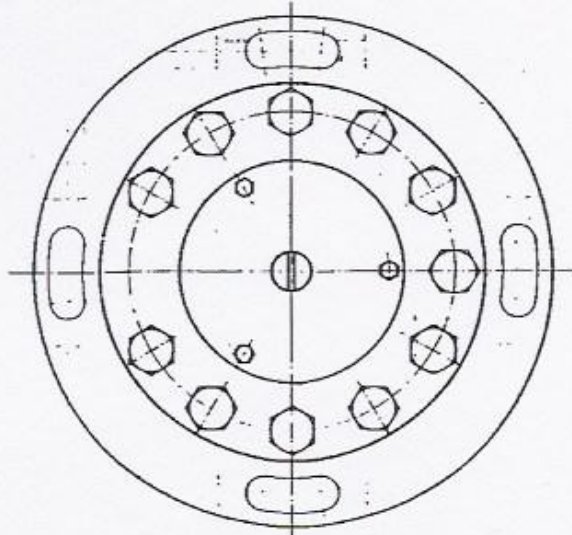
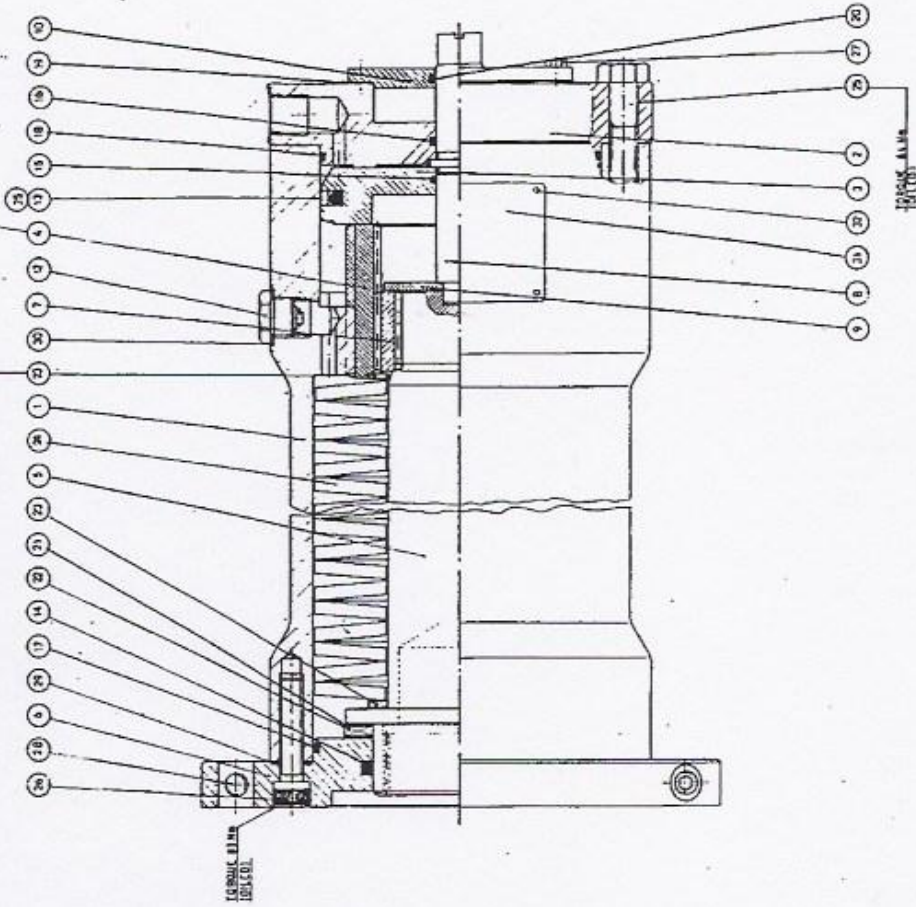

Before mounting of the piston pos.3 approx. 0.11 gear oil must be poured over the splined member pos.4.

A special tool must be used for establishing the right position of the indicator mark on the indicator shaft pos.8 as shown on the drawing.

REV.	DATE	BY	CHKD.	APP.
1				
2				
3				
4				
5				
6				
7				
8				
9				
10				
11				
12				
13				
14				
15				
16				
17				
18				
19				
20				
21				
22				
23				
24				
25				
26				
27				
28				

ASSEMBLY DRAWING  
BRCF 032  
160N 9203

DAVIDSON SYSTEMS  
HYDRAULIC DIV.